

ACCESS

It is located within GRAND GREEN OSAKA, a new area in front of Osaka Station, and is about a 7-minute walk from JR Osaka Station.

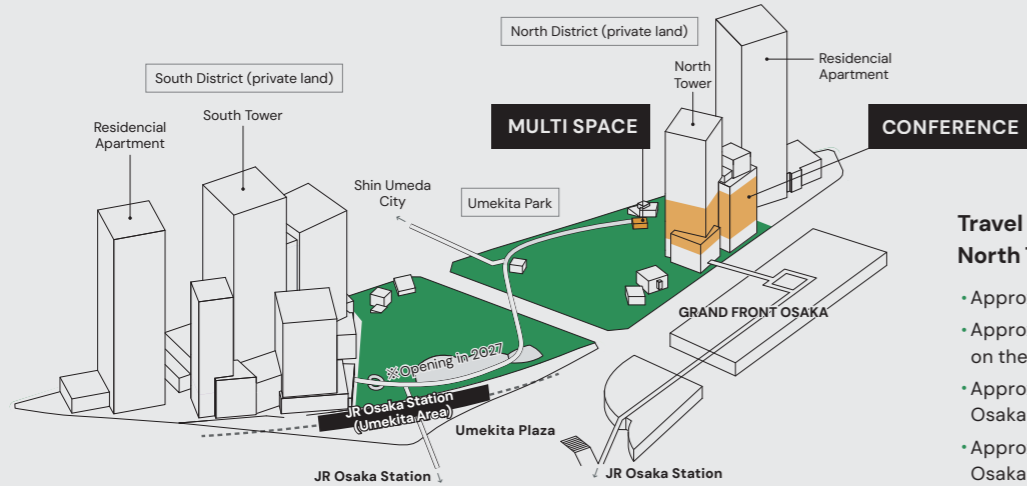

Travel time to GRAND GREEN OSAKA North Tower

- Approx. 7 minutes' walk from JR Osaka Station
- Approx. 8 minutes' walk from Umeda Station on the Osaka Metro Midosuji Line
- Approx. 7 minutes' walk from Hankyu Osaka-Umeda Station
- Approx. 10 minutes' walk from Hanshin Osaka-Umeda Station

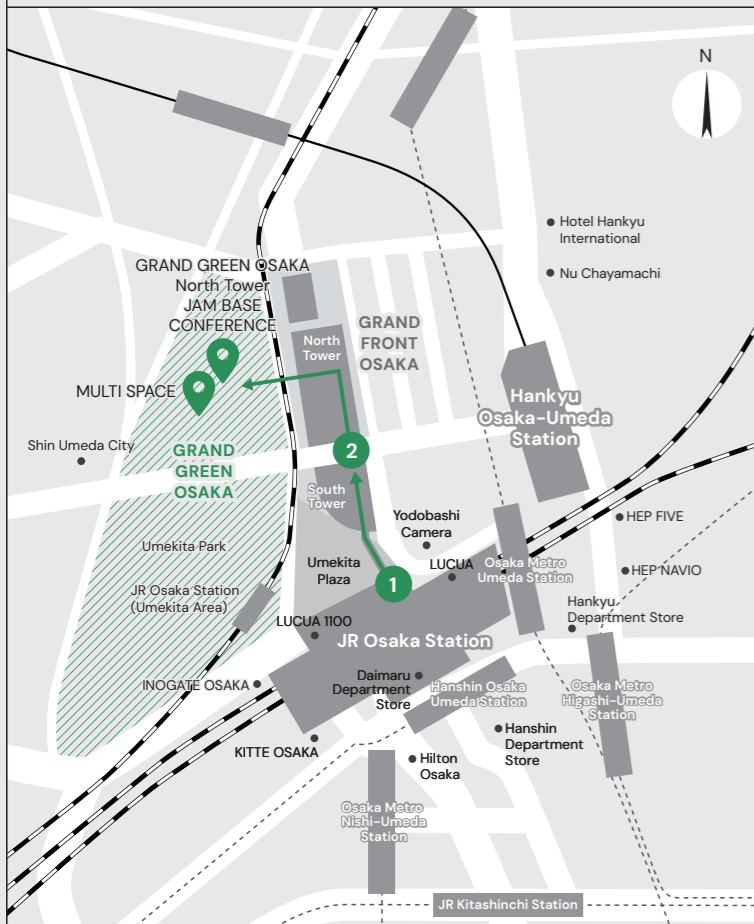

Access to the CONFERENCE and MULTI SPACE

- 1 From the JR Osaka Station North Central Gate Atrium Plaza, cross the 2nd floor connecting deck to GRAND FRONT OSAKA
- 2 From the 2nd floor of the South Building of GRAND FRONT OSAKA, go through the North Building and then through the North Connecting Bridge to GRAND GREEN OSAKA

For those coming to the CONFERENCE

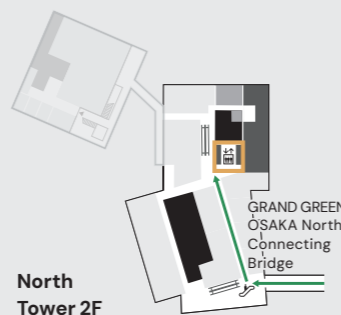

North Tower 2F

Please use the elevator to access each room.

*Please note that escalators cannot be used.

*A reception for representatives will be at the general reception desk on the 4th floor of the GRAND GREEN OSAKA North Tower.

For those coming to the MULTI SPACE

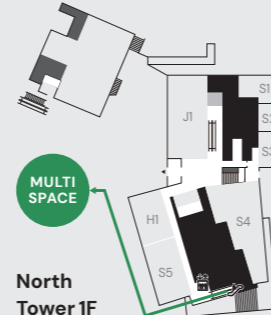

North Tower 1F

Take the front escalator to the 1st floor. Please exit the building and go to the right.

JAM BASE CONFERENCE / MULTI SPACE Guidebook

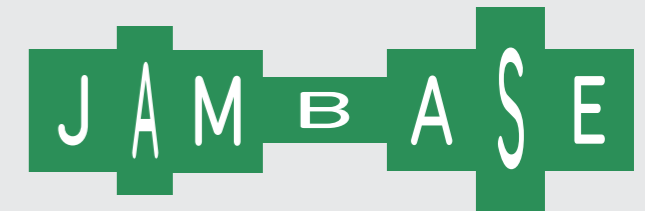

JAM BASE

"JAM BASE" is the core functional facility of GRAND GREEN OSAKA, where diverse individuals gather and interact to generate ideas and innovation. We support players such as companies, universities, research institutes, startups, and venture capital firms in working together to shape new ideas and take on the challenges of social implementation and commercialization. We aim to become a hub for innovation activities, with the private sector, government, and economic organizations working together to promote and support a variety of activities.



Contact: +81-6-6131-9527
Business hours: Weekdays 11:00 to 17:00

*For reservations, please apply online to ensure we receive accurate information.
*Please also refer to the FAQs on the website.
Official website <https://jambase-space.com/>

Co-Creation Generator (CCG)
6-38 Ofukacho, Kita-ku, Osaka 530-0011



For illustration purposes only.

Located in front of Osaka Station, surrounded by a lush urban park

GRAND GREEN OSAKA North Tower JAM BASE CONFERENCE / MULTI SPACE

With its excellent access and location, it can be used for a variety of events and any business occasion.

Seminars	Training	Company Information Sessions	Exhibitions
Academic Conferences	Presentations	Parties	Meetings
Interview Venue	Networking Events	Workshops	Test Venue

CONFERENCE

Located in the GRAND GREEN OSAKA North Tower, on the 4th to 7th floors of the JAM BASE main location. Accommodating groups from a few people up to a maximum of 285, we will recommend the optimal space based on your event details and the number of attendees.

Large Scale



CONFERENCE 6-1 & 6-2 School Style Capacity: 210 people



CONFERENCE 6-4 & 6-5 School Style Capacity: 120 people

Medium Scale



CONFERENCE 6-1 School Style Capacity: 72 people

Small Scale



CONFERENCE 6-3 Island Style Capacity: 12 people

Facility Overview

Room Name	Area	Ceiling Height	Reference Capacity				Electrical Capacity
			School Style	Theater Style	Square Style	Island Style	
CONFERENCE 5-3	32m ²	2.8m	-	-	-	12 people	1.2 kVA
CONFERENCE 6-3	32m ²	2.8m	-	-	-	12 people	1.8 kVA
CONFERENCE 7-3	32m ²	2.8m	-	-	-	12 people	1.8 kVA
CONFERENCE 6-4	104m ²	2.8m	48 people	66 people	20 people	24 people	5.4 kVA
CONFERENCE 6-5	104m ²	2.8m	48 people	66 people	20 people	24 people	6.7 kVA
CONFERENCE 4-1	105m ²	2.8m	63 people	90 people	28 people	36 people	3.0 kVA
CONFERENCE 4-2	105m ²	2.8m	63 people	90 people	28 people	36 people	3.0 kVA
CONFERENCE 5-1	125m ²	2.8m	72 people	96 people	28 people	54 people	3.5 kVA
CONFERENCE 6-1	125m ²	2.8m	72 people	96 people	28 people	54 people	3.2 kVA
CONFERENCE 7-1	129m ²	2.8m	72 people	96 people	28 people	54 people	3.0 kVA
CONFERENCE 5-2	192m ²	2.8m	105 people	135 people	36 people	72 people	5.3 kVA
CONFERENCE 7-2	196m ²	2.8m	105 people	135 people	36 people	72 people	4.4 kVA
CONFERENCE 6-2	213m ²	2.8m	120 people	150 people	40 people	72 people	5.4 kVA
CONFERENCE 6-4 & 6-5	208m ²	2.8m	120 people	154 people	40 people	60 people	*
CONFERENCE 4-1 & 4-2	210m ²	2.8m	126 people	180 people	36 people	72 people	*
CONFERENCE 5-1 & 5-2	317m ²	2.8m	195 people	270 people	56 people	126 people	*
CONFERENCE 7-1 & 7-2	325m ²	2.8m	195 people	270 people	56 people	126 people	*
CONFERENCE 6-1 & 6-2	338m ²	2.8m	210 people	285 people	56 people	126 people	*
MULTI SPACE	120m ²	3.4m	60 people	75 people	24 people	36 people	4.7 kVA

*According to the electrical capacity of each room

Services and facilities (examples)

Ceiling-mounted projector

*CONFERENCE 5-3, 6-3, and 7-3 are excluded

Ceiling-mounted screen

*CONFERENCE 5-3, 6-3, and 7-3 are excluded
*150-inch: CONFERENCE 5-1, 5-2, 6-1, 6-2, 6-4, 6-5, 7-1, 7-2
*120-inch: CONFERENCE 4-1, 4-2, MULTI SPACE

Wireless microphone, handheld

*CONFERENCE 5-3, 6-3, and 7-3 are excluded
*Maximum of 2 per room (Maximum of 4 per MULTI SPACE)

Wireless microphone, tie clip type

*CONFERENCE 5-3, 6-3, 7-3 and MULTI SPACE are excluded
*Maximum of 2 per room

Communication equipment

Wireless LAN, wired LAN (1 port in each room)
*Connections are subject to computer specifications/settings, etc.
*Security and communication speed are not guaranteed.

Catering

You can use the designated catering service to suit your purposes, such as lunch boxes and drinks during meetings, social gatherings after seminars and lectures, and party meals.

Please contact us for prices and details.

GRAND GREEN OSAKA North Tower - Floor Map

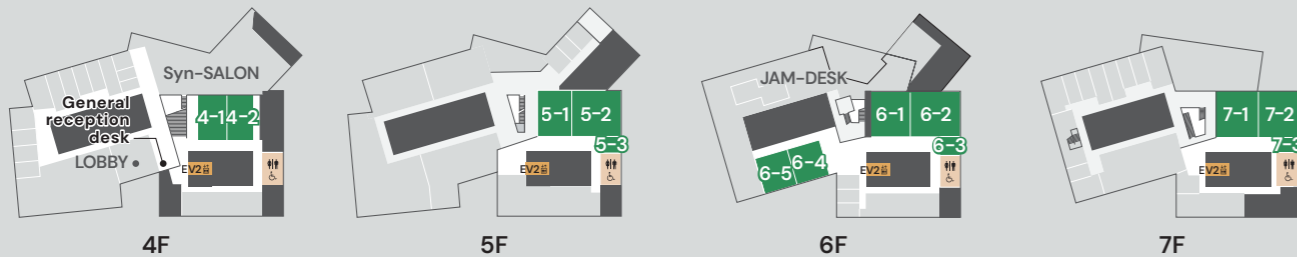

Layout example



School Style



Theater Style



Square Style



Island Style

*Layouts include school style, theater style, square style, and island style. Layout changes are not permitted for CONFERENCE 5-3, 6-3, and 7-3. Please contact us for more details.

MULTI SPACE

Within Umekita Park, there is a multi-purpose space that can be used for various corporate activities. The facility can accommodate up to 75 people and can host a variety of programs, including workshops and demonstration experiments conducted in greenery.



For illustration purposes only.

Steps to Use

- 1 Application form** Once your reservation is confirmed, our reservation staff will send you an application form. Please fill in the necessary information and reply.
- 2 Reservation fee** Once your application has been accepted, we will send you an invoice for the deposit. The reservation deposit is the total room rate described on the application form.
- 3 Meeting to discuss the event details** Approximately one month before the date of use, a person in charge of the event will contact you to discuss the details of your requirements. (The meeting may be held earlier depending on the scale and content of the event.) We accept requests for layout, rental of equipment such as microphones and projectors, as well as catering.
- 4 Flow of the day** On the day of use, please come to the general reception desk on the 4th floor of the GRAND GREEN OSAKA North Tower.
- 5 Billing for equipment fees** After using the CONFERENCE, any fees for equipment used and room extensions will be billed at a later date. (Catering will be billed directly from the catering provider.)



Availability Confirmation Form



Reservation Application Form



Other inquiry forms